

Dimension table

GE ... CW

DIN ISO 12240-1

series C

Sliding contact surface: hard chromium / Teflon® cotton fabric >> maintenance-free

Alternative markings

There is no warranty for definite equality of bearings of different suppliers!

GE ... DW

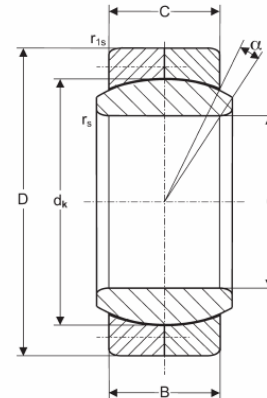

Type	Main dimensions						Mass m [kg]	Power-weight ratio kN / KG C _r /G	Load ratings	
	d [mm]	D [mm]	B [mm]	C [mm]	d _k [mm]	α [°]			C [kN]	C ₀ [kN]
GE 320 CW	320 ⁰ _{-0,008}	440 ⁰ _{-0,009}	160 ⁰ _{-0,40}	135 ⁰ _{-0,90}	22,0	4	76,0	203	1539,00	25650,00
GE 340 CW	340 ⁰ _{-0,008}	460 ⁰ _{-0,009}	160 ⁰ _{-0,40}	135 ⁰ _{-0,90}	25,0	3,8	80,0	203	16200,00	27000,00
GE 360 CW	360 ⁰ _{-0,010}	480 ⁰ _{-0,011}	160 ⁰ _{-0,40}	135 ⁰ _{-0,90}	29,0	3,6	86,0	198	17010,00	28350,00
GE 380 CW	380 ⁰ _{-0,010}	520 ⁰ _{-0,011}	190 ⁰ _{-0,40}	160 ⁰ _{-1,00}	35,5	4,1	124,5	173	21600,00	36000,00
GE 400 CW	400 ⁰ _{-0,010}	540 ⁰ _{-0,011}	190 ⁰ _{-0,40}	160 ⁰ _{-1,00}	40,7	3,9	131,0	172	22560,00	37600,00
GE 420 CW	420 ⁰ _{-0,012}	560 ⁰ _{-0,013}	190 ⁰ _{-0,40}	160 ⁰ _{-1,00}	47,0	3,7	143,0	164	23520,00	39200,00
GE 440 CW	440 ⁰ _{-0,012}	600 ⁰ _{-0,013}	218 ⁰ _{-0,45}	185 ⁰ _{-1,00}	53,0	3,9	194,0	149	28860,00	48100,00
GE 460 CW	460 ⁰ _{-0,012}	620 ⁰ _{-0,013}	218 ⁰ _{-0,45}	185 ⁰ _{-1,00}	60,0	3,7	199,0	151	29970,00	49950,00
GE 480 CW	480 ⁰ _{-0,012}	650 ⁰ _{-0,013}	230 ⁰ _{-0,45}	195 ⁰ _{-1,10}	66,0	3,8	234,0	141	33052,50	55087,50
GE 500 CW	500 ⁰ _{-0,015}	670 ⁰ _{-0,015}	230 ⁰ _{-0,45}	195 ⁰ _{-1,10}	80,0	3,6	243,0	141	34222,50	57037,50

For chamfer dimensions (r_s), fitting conditions, temperature range, internal clearance and materials see → technical data sheet

Further dimensions on inquiry

